



THE 16' PRESTIGE

At just 16 feet, one might imagine that the Prestige is a somewhat utilitarian unit, whereas nothing could be further from the truth. Take a look on the inside and see why this modestly sized portable is perhaps the most luxurious unit the industry has to offer, today. As discreet and unobtrusive as it is on the outside, the Prestige is impressive on the inside, with 3 private rooms, state of the art appliances and custom-built cabinetry. Your guests will certainly appreciate the comfort and styling of this truly special facility.

Optional amenity packages are available.

See specifications on overleaf.



The 16' Prestige



The combination of modern technology and traditional craftsmanship makes the interior of the Prestige the epitome of luxury and functionality. The custom crafted cabinets, counter tops, mouldings and frames for the beveled mirrors and the no-touch faucets and flushes all tell your guests that you've gone the extra mile to make them feel welcome and to make your event a memorable one.

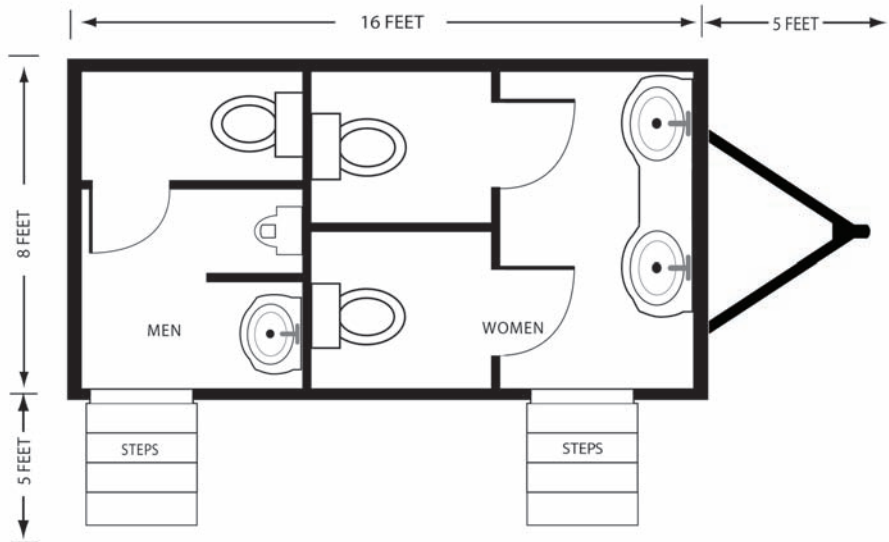

Total Footprint	29' x 21' including stairs, trailer tongue and hitch, 4' foot traffic clearance.
Accommodations	Ladies side: 2 stalls with commodes, 2 sinks with make-up mirrors in common area Men's side: 1 stall with commode, 1 urinal, 1 sinks with grooming mirror in common area. The unit is air conditioned, has a stereo sound system and hot/cold water sinks.
Capacity	The number of people served varies according to the size and nature of the event.
Electrical Power	Unit operates on three separate 110/125 volt, 20 amp circuits. These circuits must be on separate breakers and not used to power any additional equipment. Source must be within 50 feet of the unit.
Electrical Connections	Requires three (3) power cables with NEMA 5-20 connectors.
Generator	Required where adequate power is not available within 50' of the unit.
Water Supply	Unit has a standard garden hose connection. A spigot with compatible connector and functioning turn-off valve is required within 50' of the unit.
Auxiliary Water Supply	Required where water or adequate water pressure (30-60 psi) is not available.